

STEP 1

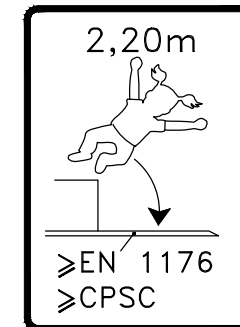

428 001 99
420 741 14
426 200
416 213 04
420 080 10
Hags.no. 4180-03

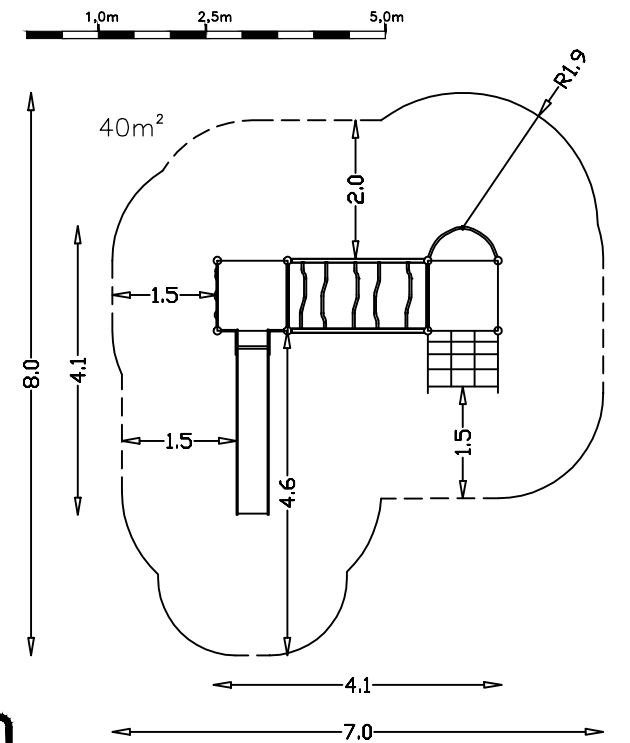
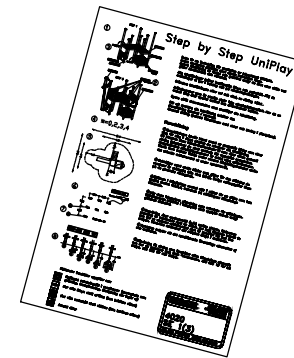
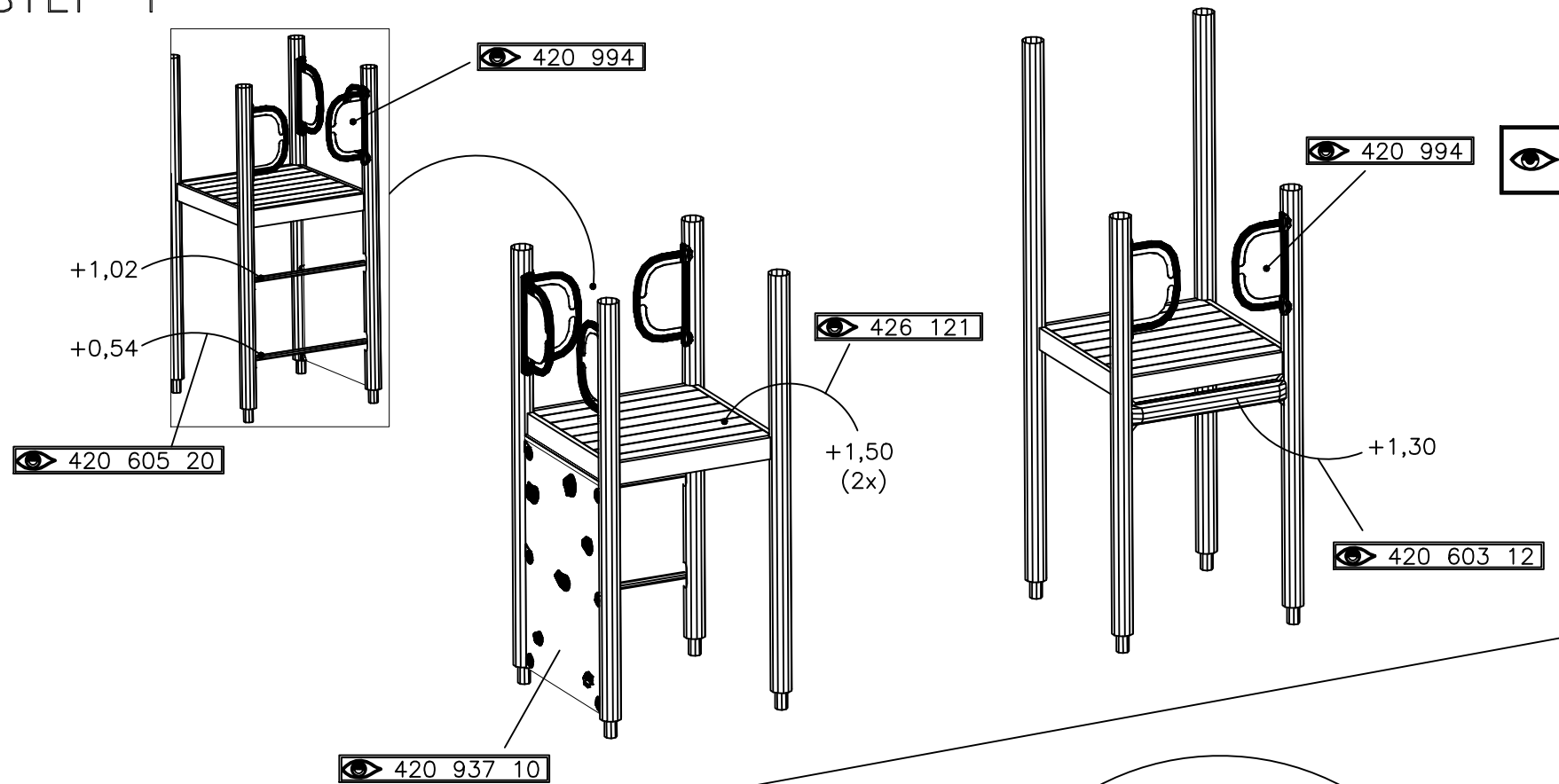
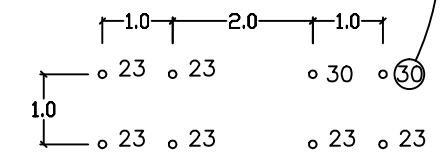

STEP 2

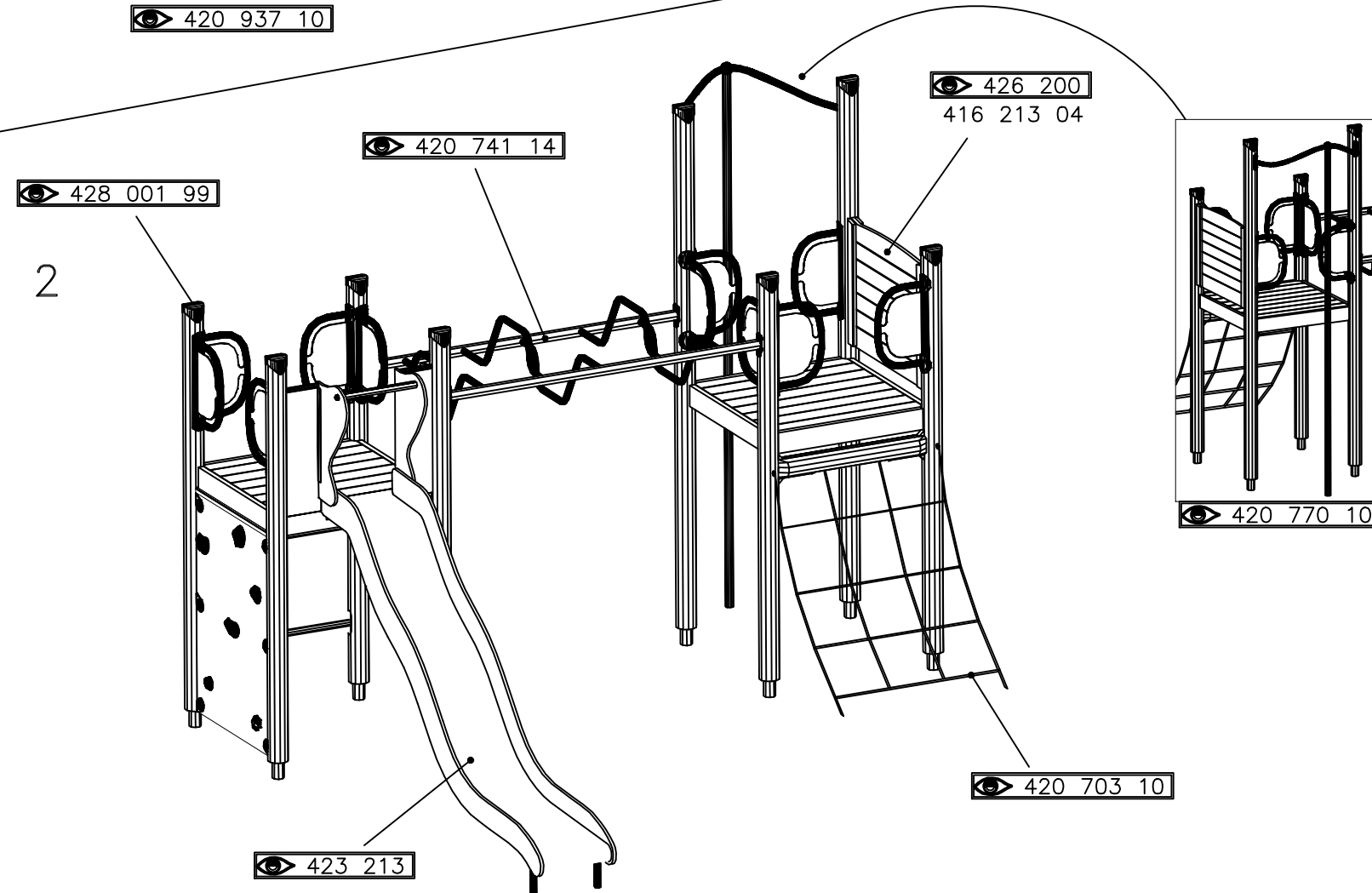

22 h



Varje vecka
Every week
Jede woche
Chaque semaine



Varje säsong
Every season
Jedes Jahr
Chaque saison



5-12

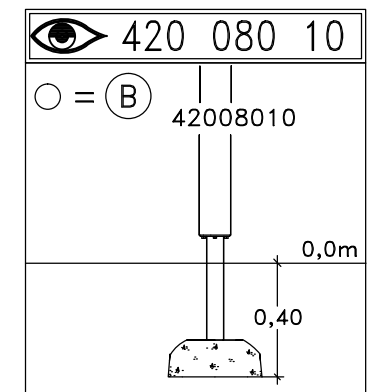

HAGS ANEBY, SWEDEN
+46(0)380-47300
www.hags.com

Ossion
8009351
1(1)

AM LN 2017-08-15 1